

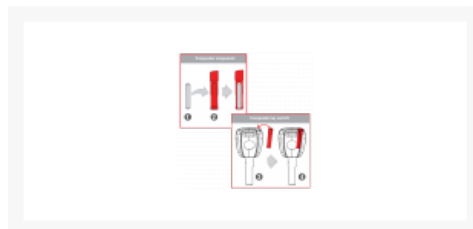

## SILCA MIT11RTE Case Only To Suit Citroën, Mitsubishi & Peugeot

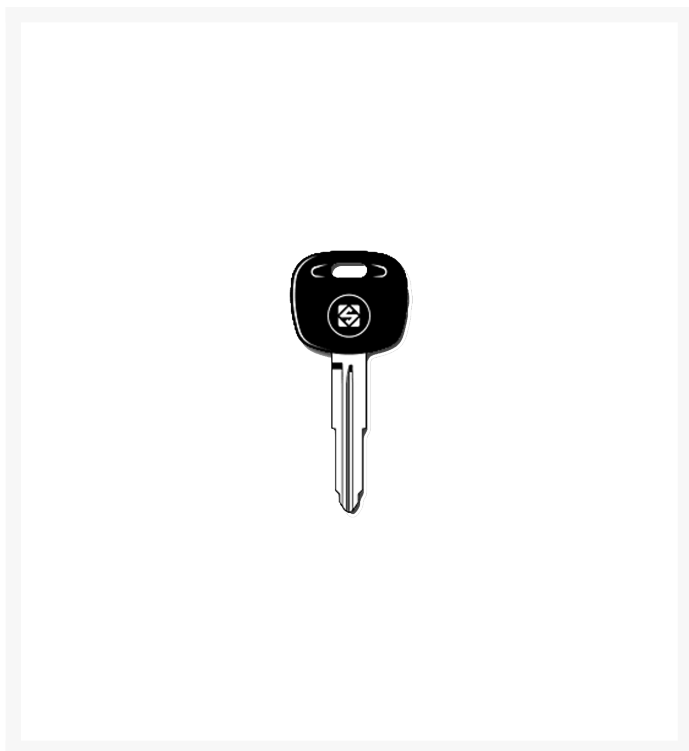

### Description

A case only blank to take the Silca GTI transponder chip, suitable for MITSUBISHI models 380 (From 2006 Ongoing), COLT (From 1996 To 2000), ECLIPSE (From 2008 To 2012), ENDEAVOR (From 2007 To 2011), GALANT (USA) (From 2008 To 2012), GALANT (From 2006 Ongoing), GRANDIS (From 2003 Ongoing), I-MiEV (From 2010 Ongoing), LANCER SW (From 1996 To 2003), LANCER (From 1996 To 2003), LANCER (From 2003 To 2006), LANCER (From 2006 Ongoing), MIRAGE (From 1996 To 2002), MONTERO IO (From 2000 To 2006), OUTLANDER (From 2004 To 2006), OUTLANDER (From 2006 Ongoing), PAJERO IO (From 1999 To 2004), PAJERO MINI [J] (From 1999 Ongoing), PAJERO PININ (From 1999 To 2004), PAJERO PININ (From 1999 To 2004) & SHOGUN PININ (From 1999 To 2004).

It is also suitable for CITROËN models C-CROSSER (From 2007 Ongoing) & C-ZERO (From 2011 Ongoing) and PEUGEOT models 4007 (From 2007 Ongoing) & ION (From 2011 Ongoing).



8 Pin Mechanism



Cylinder Key

## Features

---

- Takes a Silca GTI Chip
- To Suit Citroen, Mitsubishi & Peugeot

## Product Table

---

	<div>L22656</div> <div>MIT11RTE - No Chip</div>
---	---