

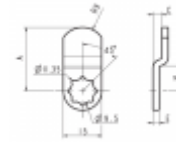

RONIS 131629-3 Cranked Cam



Description

RONIS 131629 type 3 cam is cranked style meaning that it has 2 bends in it making it offset. It is 15mm wide, 2.5mm thick, has a radius end, 9.5mm fixing hole and can be mounted in one of 8 positions in 45° increments.



Reversible Handling

Features

- Cranked Construction
- 9.5mm hole
- 15mm wide
- To suit Ronis cam locks
- Cam bar only

Product Table



L26834

30mm With 3mm Crank



L26835

40mm With 2mm Crank



L26836

50mm With 2mm Crank



L26837

50mm With 3mm Crank