

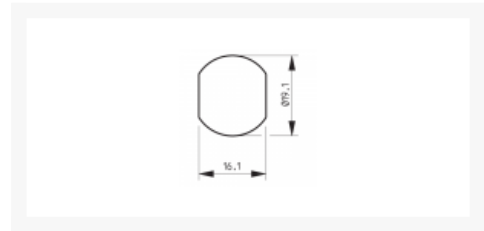

RONIS 25300 Nut Fix Master Keyed Camlock



Description

RONIS 25300 Wafer Camlock is supplied under the CC Master Key Series in a Bright Chrome Finish.



Supplied With 2
Keys



Cylinder Key



Master Keyed

Features

| |
|--------------------------|
| - Nut Fixing |
| - 19.5mm Body Length |
| - Round Face |
| - CC Key Series |
| - 2,000 Key Combinations |

Product Table

| | |
|---|--|
|  | L26810 19.5mm MK (CC Series) |
|---|--|