

Description

The Zenith sliding door gear from Henderson is designed for use on sliding glass cupboard doors weighing up to 25Kg and measuring up to 6mm thick. Using precision-made, satin anodised finish aluminium gear and brush pile strips, the Zenith ensures a smooth and quiet operation. Three kits can be used to give a maximum opening width of 1800mm.

Kit Contains:

- 1x Top Guide Channel
- 2x Glass Rails
- 4x Bottom Rollers
- 4x Endcaps
- 1x Bottom Rail
- 2x Glazing Strip

Features

- Three sizes of kit available
- To suit glass doors weighing up to 25Kg
- A precision made, satin-anodised finish aluminium gear with brush-pile strips in guide rail
- For showcases, book cases, display panels, hatches, interior windows and glass doors

Product Table

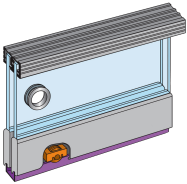

1298
1200mm

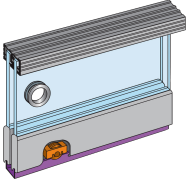

1300
1500mm

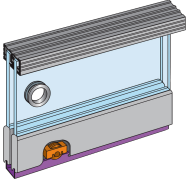

1302
1800mm