

DORMAKABA ED100 LE XEA Low Energy Swing Door Operator

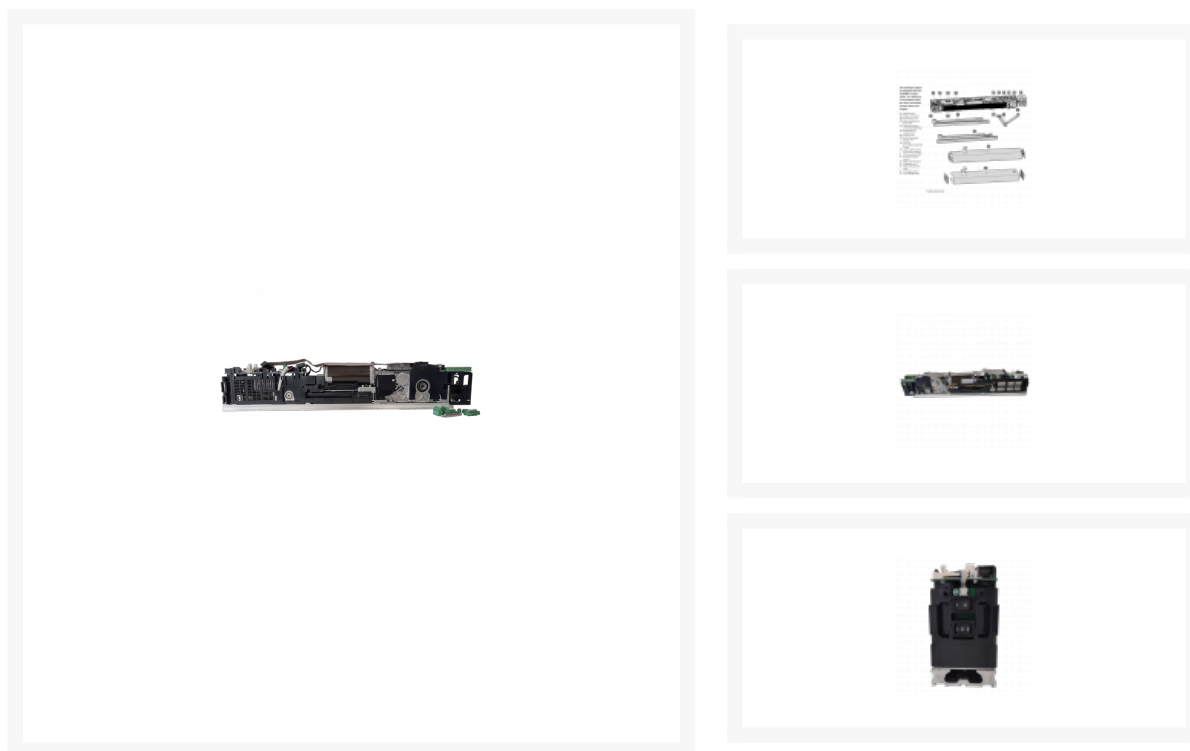

Description

The dormakaba ED100 LE XEA is a low energy electromechanical swing door operator suitable for use on emergency escape routes as well as on fire and smoke check doors. Tested to 1,000,000 cycles this modular unit is suitable for both single and double leaf doors up to a weight of 160kg and a maximum door width of 1100mm. An elegant XEA design provides an operator height of only 70mm and the modular design makes it easy to replace parts should the need arise.



Size 2 to 4



Adjustable
Closing Action



Adjustable Latch
Action



Fire Tested

Features

- Efficient closing due to an electronic latching action
- XEA design provides an operator height of only 70mm
- Suitable for use on emergency escape and fire doors
- Allows for manual door operation with push-pad activated assistance on demand
- Additional parts are required for successful installation
- Low noise levels through multi-stage gearing
- Suitable for single or double-leaf swing doors.
- Tested to 1,000,000 cycles

Product Table

	<div>L33683</div> <div>Door Operator - 29222311</div>
---	--