

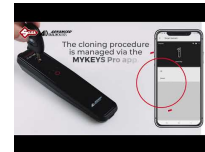

ADVANCED DIAGNOSTICS ADC245 Smart Aerial Plus



Description

The Smart Aerial+ from Advanced Diagnostics is an easy to use, reliable cloning device. It is compatible with all existing Silca cloning capabilities and has WiFi and bluetooth connectivity. All cloning calculations are done via the cloud and there is new cloning capability for Mazda 8 C Temic which is not available on RW4+.

It is a lightweight, portable device with an internal rechargeable battery and comes with USB cable and mains charging cable which features a universal AC adaptor.

Please note: Currently does not support ID49-1C HI tag AES. Advanced Diagnostics are currently working on software to enable this with the Smart Aerial Plus.

Features

- New device connect with MKP to guide the customer through the cloning process
- Compatible with GTI Pro
- All cloning calculations done via cloud
- Compatible with all existing Silca cloning capabilities
- New cloning capability for Mazda 8 C Temic, not available for RW 4
- U Snoop functions integrated
- WiFi and Bluetooth connectivity
- Cloud cloning device with intuitive software associated to MYKEYS Pro

Product Table



L32900

D854589AD